

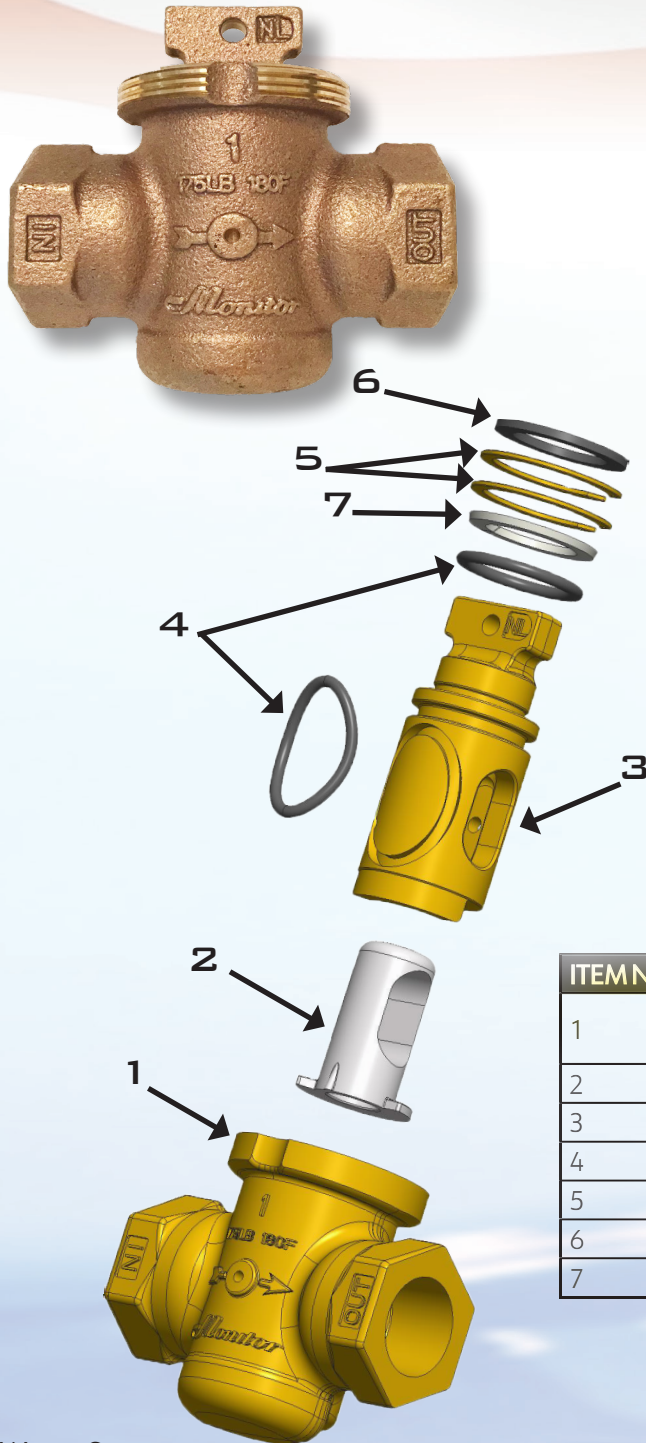

# CURB VALVES



## Features:

- Sizes: 3/4", 1", 1 1/4", 1 1/2" and 2"
- FIP threaded connections
- High quality lead-free, red brass C89844
- Pressure tested to 175 PSIG in open and closed positions
- Drain option available
- Minneapolis style threaded top
- Heavy duty construction to resist ground and pipe stress
- Precisely machined surfaces with a chamfered edge provide a positive seal allowing the valve to open and close with minimal force
- One piece closed body minimizes dirt and groundwater contamination and reduces possible leakage points
- NSF/ANSI 61 certified

ITEM NO.	PART NO.	DESCRIPTION	QTY
1	1CVDLFM	1" CURB VALVE BODY, CASTED & MACHINED, WITH DRAIN	1
2	1CVINSERT	1" CURB VALVE INSERT	1
3	1CVLFKEY	1" CURB VALVE KEY, MACHINED	1
4	1CVORING	1" CURB VALVE O-RING	2
5	1CVRR	1" CURB VALVE RETAINING RING	2
6	1CVTS	1" CURB VALVE TOP SEAL	1
7	1CVTW	1" CURB VALVE THRUST WASHER	1

Baker Water Systems  
 133 Enterprise St., Evansville, WI 53536  
 800-356-5130 Fax: 608-882-3777  
 MonitorSales@Baker-Mfg.com  
 BakerWaterSystems.com

20230322

